



Lush Green Living,
Where Nature Meets Home.

www.sriamaara.com



About Us

Sri Amaara Infra Tech is a progressive construction company, building on the success of Aaryan Homes, which has over a decade of delivering quality residential and commercial projects. Known for trust, commitment, and expertise, Sri Amaara combines modern construction techniques with sustainable practices to exceed client expectations. With a focus on meticulous planning, high-quality materials, skilled craftsmanship, and transparent pricing, the company continues to deliver functional and aesthetically appealing infrastructure.



**Experience
Spacious Living
Amidst Lush Green
Surroundings at
Amaara Akira.**

**Lush Green Living,
Where Nature Meets Home.**

ONLY 1.30 KMS FROM THE METRO STATION

Education

- Millennium World School 900m
- CBSC Westline Public School 260m
- Cambridge High School 3km
- Oxford English School 2.4km
- National Public School 1km

Healthcare

- Sparsh Hospital Sri 2.6km
- Maruthi Hospital Dhaara 1km
- Speciality Hospital Navya 2.5km
- Multispecialty Hospital 2.3km
- Ayu Hospital 2.1km

Landmarks

- Sobha Palm Courts 1.5km
- Adarsh Greens
- Bhartiya City Nikoo 5km
- Homes Mittal Elanza 2.5km
- Legacy Eldora 2.5km

Hospitality

- The Galleria Mall Kurlappa 3.1km
- Shopping Complex 1.1km
- Elements Mall BDK 5km
- Shopping Complex Bhartiya 2.3km
- mall of Bangalore 5km

And much more. Call us to know more.

Location  Click me 

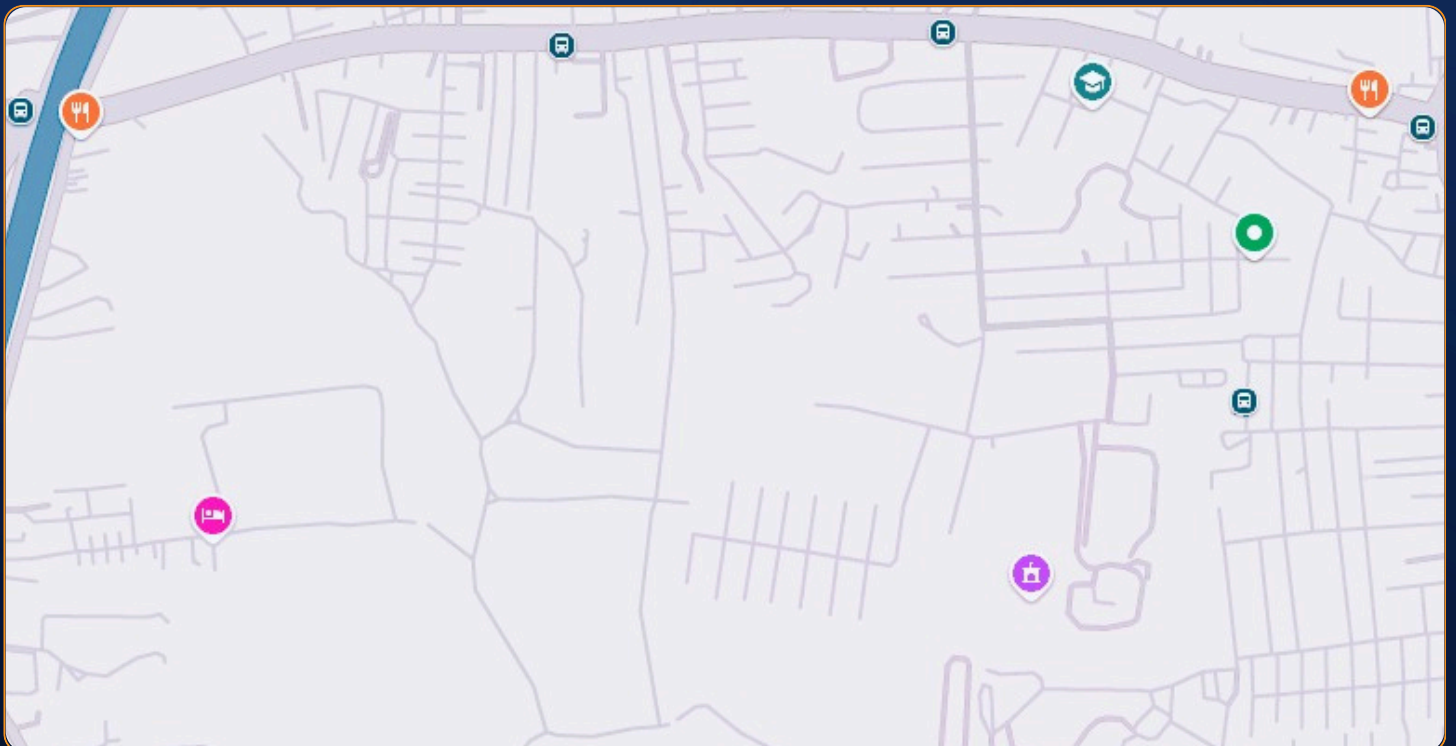

Projects Highlights



24 x 7 Water Supply



Lift Service



Lush Green Environment



CCTV Surveillance



24 x 7 Power Backup

- **Number of Floors: Parking + 5**
- **Number of Flats: 9**
- **Only 2 Flats per Floor**
- **1 Car Parking Lot per Unit**
- **100% Vaastu Compliant**
- **Lavish Sized Rooms**
- **Teak Wood Main Doors**
- **Spacious Balconies and Terrace**
- **High-End Material Finishes**
- **Covered Car Park**



Typical Floor Plan



Floor

Flat No.

Super Built Up Area (Sq. Ft.)

First Floor

F101
F102

1350.5
1350.5

Second
Floor

F201
F202

1350.5
1350.5

Third Floor

F301
F302

1350.5
1350.5

Unit 1 (2 BHK)

Unit 1 is a spacious 2 BHK with built up area of 1350.5 sq.ft.

Isometric View



Top View



Unit 1 is a spacious 2 BHK with built up area of 1350.5 sq.ft.

Attached Balcony

A Spacious Living Room

2 Washrooms

A Spacious Living Room

Modular Kitchen

Super Ventilated

Unit 2 (2 BHK)

Unit 2 is a spacious 2 BHK with built up area of 1350.5 sq.ft.



Isometric View

Top View



Unit 2 is a spacious 2 BHK with built up area of 1350.5 sq.ft.

Attached Balcony

A Spacious Living Room

2 Washrooms

Road-Facing Balconies

Modular Kitchen

Super Ventilated

Unit 3 (Duplex 3 BHK)

Unit 3 is a spacious Duplex 3 BHK with built up area of 1966 sq.ft.



Level 1 - Top View

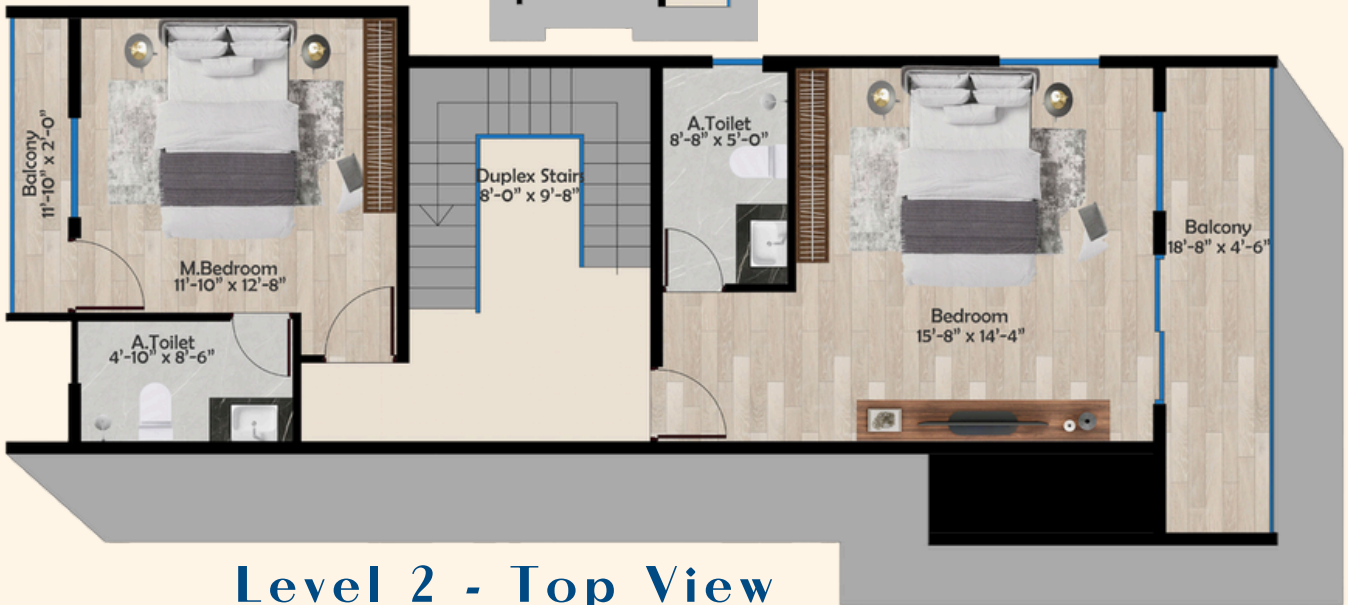

Level 2 - Top View

Unit 3 is a spacious Duplex 3 BHK with built up area of 1966 sq.ft.

3 BHK Duplex with a total area of 1810 sq. ft

Expansive Living and Dining Area

Attached Balconies

Modular Kitchen with Modern Appliances

3 Washrooms

High Ceilings & Large Windows for Natural Light

UNIT 4 [3 BHK]

Unit 4 is a spacious 3 BHK with a built up area of 1495 sq.ft.



Isometric View

Top View



Unit 4 is a spacious 3 BHK with a built up area of 1495 sq.ft.

Spacious Bedrooms with Attached Balconies

Modular Kitchen

3 Washrooms (All Attached)

Well-Ventilated Rooms

Open Plan Living and Dining Area

Balcony Overlooking Scenic Views

UNIT 5 [3 BHK]

Unit 5 is a spacious 3 BHK with a built up area of 1800 sq.ft.



Isometric View

Top View



Unit 5 is a spacious 3 BHK with a built up area of 1800 sq.ft.

Spacious Bedrooms with Attached Balconies

Modular Kitchen

3 Washrooms (All Attached)

Well-Ventilated Rooms

Open Plan Living and Dining Area

Balcony Overlooking Scenic Views



Lush Green Living,
Where Nature Meets Home.

Contact Us Here:

Phone Number: +91 9880053505

Website: www.sriamaara.com